

| 代号 | 名称            | 数量 | 序号 | 代号            | 名称            | 数量 | 序号 | 代号           | 名称            | 数量 | 序号  | 代号             | 名称            | 数量 | 序号  |
|----|---------------|----|----|---------------|---------------|----|----|--------------|---------------|----|-----|----------------|---------------|----|-----|
| 1  | 螺栓组合件 M5 × 10 | 1  | 30 | GB9074.13     | 螺栓组合件 M5 × 20 | 2  | 59 | IE34F-E-8    | 螺栓组合件 M5 × 20 | 1  | 88  | IE34F-E-8      | 螺栓组合件 M5 × 20 | 1  | 88  |
| 2  | 螺栓组合件 M5 × 10 | 1  | 31 | IE34F-E-11    | 螺栓组合件 M5 × 20 | 2  | 60 | GB/T9074.4   | 螺栓组合件 M5 × 25 | 2  | 89  | IE34F-E-2-3A   | 螺栓组合件 M5 × 25 | 2  | 89  |
| 3  | 启动绳           | 1  | 32 | IE34F-E-10-1  | 启动绳           | 1  | 61 | IE34F-E-11   | 启动绳           | 1  | 90  | IE34F-E-2      | 启动绳           | 1  | 90  |
| 4  | 启动绳           | 1  | 33 | IE34F-E-10-1  | 启动绳           | 1  | 62 | HA28.1       | 启动绳           | 1  | 91  | GB9074.4       | 启动绳           | 1  | 91  |
| 5  | 启动绳           | 1  | 34 | IE34F-E-13    | 启动绳           | 2  | 63 | HA28.1-3     | 启动绳           | 1  | 92  | HA28.7.1       | 启动绳           | 2  | 92  |
| 6  | 启动绳           | 1  | 35 | IE34F-E-12    | 启动绳           | 2  | 64 | HA28.1-3A    | 启动绳           | 1  | 93  | IE32FL.6.2     | 启动绳           | 1  | 93  |
| 7  | 启动绳           | 1  | 36 | GB 845        | 启动绳           | 2  | 65 | GB 6170      | 启动绳           | 1  | 94  | IE32FL.6.2-4   | 启动绳           | 1  | 94  |
| 8  | 启动绳           | 1  | 37 | HA28.4-1      | 启动绳           | 1  | 66 | HA28.4-1-2   | 启动绳           | 1  | 95  | IE32FL.6.2-3   | 启动绳           | 1  | 95  |
| 9  | 启动绳           | 4  | 38 | HA28.4-1-1    | 启动绳           | 1  | 67 | GB/T845      | 启动绳           | 1  | 96  | IE32FL.6.2-2   | 启动绳           | 1  | 96  |
| 10 | 启动绳           | 1  | 39 | HA28.4-1-2    | 启动绳           | 1  | 68 | GB/T 70.1    | 启动绳           | 1  | 97  | IE32FL.6.2-1   | 启动绳           | 1  | 97  |
| 11 | 启动绳           | 2  | 40 | GB97.1        | 启动绳           | 6  | 69 | HA28.1-2     | 启动绳           | 1  | 98  | IE32FL.6.2-1-1 | 启动绳           | 1  | 98  |
| 12 | 启动绳           | 1  | 41 | GB93          | 启动绳           | 6  | 70 | HA28.1-2     | 启动绳           | 1  | 99  | IE32FL.6.2-1-1 | 启动绳           | 1  | 99  |
| 13 | 启动绳           | 1  | 42 | GB97.1        | 启动绳           | 6  | 71 | HA28.1-1     | 启动绳           | 1  | 100 | IE32FL.6.2-1-1 | 启动绳           | 1  | 100 |
| 14 | 启动绳           | 1  | 43 | CC305F-HS.1-2 | 启动绳           | 4  | 72 | L8RTTC       | 启动绳           | 1  | 101 | IE32FL.6.2-1-1 | 启动绳           | 1  | 101 |
| 15 | 启动绳           | 2  | 44 | CC305F-HS.1-3 | 启动绳           | 1  | 73 | IE40F-2A.8-2 | 启动绳           | 1  | 102 | IE40F-2A.8-2   | 启动绳           | 1  | 102 |
| 16 | 启动绳           | 1  | 45 | CC305F-HS.1-1 | 启动绳           | 1  | 74 | HA28.2.1-1   | 启动绳           | 1  | 103 | HA28.2.1-1     | 启动绳           | 1  | 103 |
| 17 | 启动绳           | 1  | 46 | GB97.1        | 启动绳           | 2  | 75 | IE40F-2.3-1  | 启动绳           | 2  | 104 | IE40F-2.3-1    | 启动绳           | 2  | 104 |
| 18 | 启动绳           | 2  | 47 | GB93          | 启动绳           | 2  | 76 | GB845        | 启动绳           | 2  | 105 | IE40F-2.3-1    | 启动绳           | 2  | 105 |
| 19 | 启动绳           | 1  | 48 | GB97.1        | 启动绳           | 2  | 77 | HA28.3-2     | 启动绳           | 2  | 106 | IE40F-2.3-1    | 启动绳           | 2  | 106 |
| 20 | 启动绳           | 1  | 49 | GB97.4.4      | 启动绳           | 1  | 78 | HA28.3-1     | 启动绳           | 1  | 107 | IE40F-2.3-1    | 启动绳           | 1  | 107 |
| 21 | 启动绳           | 2  | 50 | IE31E.4.1     | 启动绳           | 1  | 79 | GB846        | 启动绳           | 2  | 108 | IE40F-2.3-1    | 启动绳           | 2  | 108 |
| 22 | 启动绳           | 1  | 51 | IE34F-E-2     | 启动绳           | 2  | 80 | HA28-1       | 启动绳           | 2  | 109 | IE40F-2.3-1    | 启动绳           | 2  | 109 |
| 23 | 启动绳           | 1  | 52 | IE34F-E-4-1   | 启动绳           | 1  | 81 | IE34F-E-2    | 启动绳           | 1  | 110 | IE34F-E-2      | 启动绳           | 1  | 110 |
| 24 | 启动绳           | 4  | 53 | IE34F-E-6-5   | 启动绳           | 1  | 82 | IE34F-E-2    | 启动绳           | 1  | 111 | IE34F-E-2      | 启动绳           | 1  | 111 |
| 25 | 启动绳           | 1  | 54 | IE34F-E-5     | 启动绳           | 2  | 83 | GB70.1       | 启动绳           | 2  | 112 | IE34F-E-2      | 启动绳           | 2  | 112 |
| 26 | 启动绳           | 1  | 55 | IE34F-E-3     | 启动绳           | 1  | 84 | HA28-2       | 启动绳           | 1  | 113 | IE34F-E-2      | 启动绳           | 1  | 113 |
| 27 | 启动绳           | 1  | 56 | IE34F-E-1     | 启动绳           | 1  | 85 | GB/T845      | 启动绳           | 1  | 114 | IE34F-E-2      | 启动绳           | 1  | 114 |
| 28 | 启动绳           | 1  | 57 | GB/T70.1      | 启动绳           | 4  | 86 | GB/T3527.1   | 启动绳           | 4  | 115 | IE34F-E-2      | 启动绳           | 4  | 115 |
| 29 | 启动绳           | 1  | 58 | IE34F-E-8     | 启动绳           | 1  | 87 | IE305F-E-8   | 启动绳           | 1  | 116 | IE34F-E-2      | 启动绳           | 1  | 116 |

分解图 2: BC28割灌机具部分分解图

FIG. 2: The Parts List of Model BC28 Brush Cutter

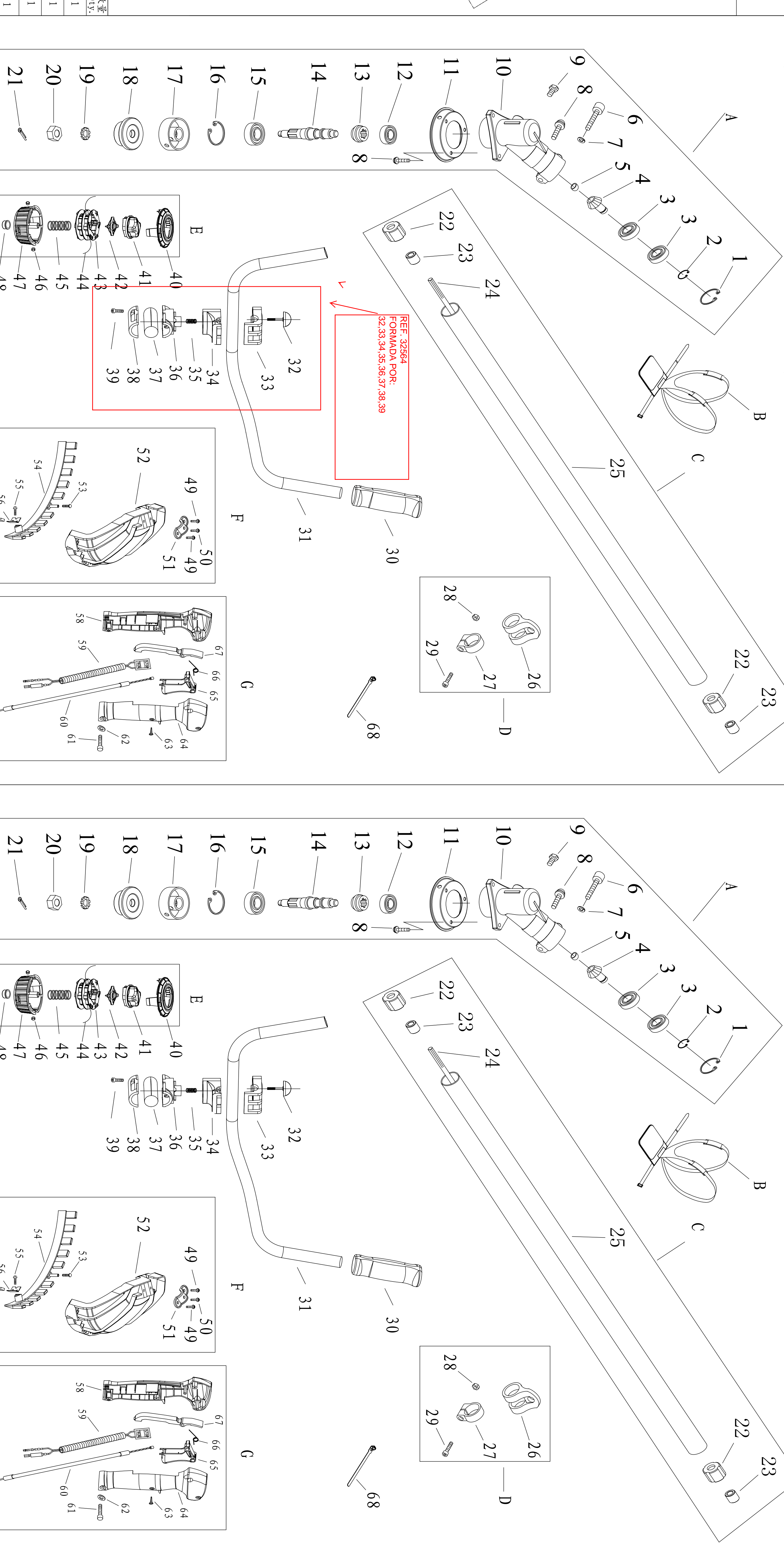

| 代号 | 名称    | 数量 | 序号 | 代号           | 名称         | 数量 | 序号 | 代号            | 名称  | 数量 | 序号 | 代号           | 名称    | 数量 | 序号 |
|----|-------|----|----|--------------|------------|----|----|---------------|-----|----|----|--------------|-------|----|----|
| 1  | 齿轮箱组合 | 1  | 23 | BC-328.9.4-4 | 含油轴承       | 6  | 46 | BC36.5-5      | 软绳套 | 2  | A  | CC415.3      | 齿轮箱组合 | 1  | 23 |
| 2  | 轴衬    | 1  | 24 | CC420.2-3    | 硬轴         | 1  | 47 | BC36.5.1      | 绳套  | 1  | 47 | GB/T893.2    | 轴衬    | 1  | 24 |
| 3  | 轴衬    | 1  | 25 | BC28.1-1     | 轴套         | 1  | 48 | BC36.5-1-1    | 绳套  | 1  | 48 | GB/T894.1    | 轴衬    | 1  | 25 |
| 4  | 轴衬    | 1  | 26 | CC260.3.1    | 提环         | 1  | 49 | GB/T770.1     | 绳套  | 1  | 49 | CC415D.6-4   | 轴衬    | 1  | 26 |
| 5  | 轴衬    | 1  | 27 | CC260.3-1    | 提环         | 1  | 50 | GB/T770.1     | 绳套  | 1  | 50 | CC415.3-1    | 轴衬    | 1  | 27 |
| 6  | 轴衬    | 1  | 28 | GB/T889.1    | 螺母 M5      | 1  | 51 | BC36.4-1      | 绳套  | 1  | 51 | GB/T70.1     | 轴衬    | 1  | 28 |
| 7  | 轴衬    | 1  | 29 | GB/T70.1     | 螺母 M5 × 20 | 1  | 52 | BC36.4.1      | 绳套  | 1  | 52 | GB/T93       | 轴衬    | 1  | 29 |
| 8  | 轴衬    | 1  | 30 | BC36-8       | 左把板        | 1  | 53 | GB/T845       | 绳套  | 1  | 53 | GB/T9074.4   | 轴衬    | 1  | 30 |
| 9  | 轴衬    | 1  | 31 | BC36-6       | 手把         | 1  | 54 | CC420.7.1.1-1 | 绳套  | 1  | 54 | GB/T9074.11  | 轴衬    | 1  | 31 |
| 10 | 轴衬    | 1  | 32 | BC36.2       | 橡胶垫板组合     | 1  | 55 | GB/T845       | 绳套  | 1  | 55 | BC305.12.4-4 | 轴衬    | 1  | 32 |
| 11 | 轴衬    | 1  | 33 | BC36-5       | 手把下压板      | 1  | 56 | BC46.2.2-1    | 绳套  | 1  | 56 | BC305.12.4-4 | 轴衬    | 1  | 33 |
| 12 | 轴衬    | 1  | 34 | BC36-3       | 刀片罩        | 1  | 57 | BC46.2.2-1    | 绳套  | 1  | 57 | BC300H.7.3-1 | 轴衬    | 1  | 34 |
| 13 | 轴衬    | 1  | 35 | BC36-4       | 刀片罩        | 1  | 58 | BC36.3.3      | 绳套  | 1  | 58 | BC305F.1-3   | 轴衬    | 1  | 35 |
| 14 | 轴衬    | 1  | 36 | BC36-2       | 压簧         | 1  | 59 | BC36.3.2      | 绳套  | 1  | 59 | BC305F.1-3   | 轴衬    | 1  | 36 |
| 15 | 轴衬    | 1  | 37 | BC36-10      | 转向座        | 1  | 60 | BC36.3.1      | 绳套  | 1  | 60 | BC305F.1-3   | 轴衬    | 1  | 37 |
| 16 | 轴衬    | 1  | 38 | BC36-5       | 转向座        | 1  | 61 | BC36.3.2      | 绳套  | 1  | 61 | BC305F.1-3   | 轴衬    | 1  | 38 |
| 17 | 轴衬    | 1  | 39 | GB/T70.1     | 螺母 M5 × 16 | 2  | 62 | GB/T848       | 绳套  | 2  | 62 | BC305F.1-3   | 轴衬    | 1  | 39 |
| 18 | 轴衬    | 1  | 40 | BC36.5       | 绳套组合       | 1  | 63 | GB/T845       | 绳套  | 1  | 63 | BC305F.1-3   | 轴衬    | 1  | 40 |
| 19 | 轴衬    | 1  | 41 | BC36.5-2     | 绳套         | 1  | 64 | BC36.5-1      | 绳套  | 1  | 64 | GB/T862.1    | 轴衬    | 1  | 41 |
| 20 | 轴衬    | 1  | 42 | BC36.5-3     | 绳套         | 1  | 65 | BC36.3-6      | 绳套  | 1  | 65 | CC305F.1-4   | 轴衬    | 1  | 42 |
| 21 | 轴衬    | 1  | 43 | BC36.5-4     | 绳套         | 1  | 66 | BC36.3-5      | 绳套  | 1  | 66 | GB/T91       | 轴衬    | 1  | 43 |
| 22 | 轴衬    | 1  | 44 | BC36.5-6     | 绳套         | 1  | 67 | BC36.3-3      | 绳套  | 1  | 67 | CC305F.1-4   | 轴衬    | 1  | 44 |
| 23 | 轴衬    | 2  | 68 | BC36-15      | 绳套         | 2  | 68 | BC36-15       | 绳套  | 2  | 68 | BC-328.9.4-5 | 轴衬    | 2  | 68 |